



ACCUWEIGH

Onboard and Vehicle
Weighing Systems

XW200 ACCELEROMETER

Radio-operated accelerometer for material
handlers up to 120t lifting capacity.

DESCRIPTION

The XW200 is a wireless, weighing flange accelerometer for material handlers up to 120 tonne lifting capacity and mounting between rotator and grab.

The XW200 can also be used as base unit for the construction of a weighing link (dimensions of the crane boom and rotator are required).

UNI REMOTE

The UNI Onboard Computer is ideal for use with the XW200 wireless Accelerometer, typically fitted to mobile cranes, excavators, lifters, etc.



UNI OBOARD COMPUTER

FEATURES

- Direct Power Supply
- Continuous Weight Display
- Automatic and Non-Automatic Weighing (Non-Automatic Weighing is Typical)
- 6 x Memory Slots
- Automatic Adding
- Power Supply: 18-35VDC
- Software: BlueScale
- Type Approval: OIML R51 Class y(b), 500e
- Protection Class: IP-65
- Bluetooth Interface for Printer
- USB Contact for Software Upgrade and Storage of Weighing Data on a USB Flash Drive

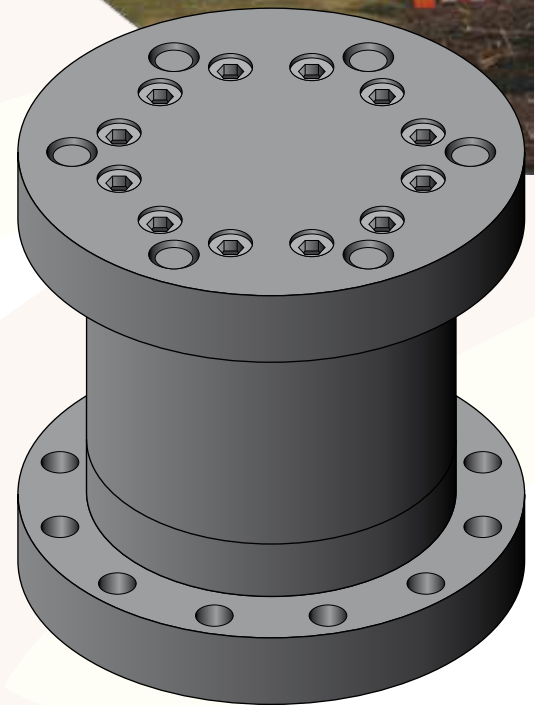

XW200 ACCELEROMETER

Accuweigh Pty Ltd

WESTERN AUSTRALIA (HEAD OFFICE):
PHONE: (08) 9259 5535

SOUTH AUSTRALIA OFFICE:
PHONE: (08) 8447 5011

NEW SOUTH WALES (SYDNEY) OFFICE:
PHONE: (02) 9728 4877



www.accuweigh.com.au

VICTORIA OFFICE:
PHONE: (03) 9548 5554

NEW SOUTH WALES (NEWCASTLE) OFFICE:
PHONE: (02) 4966 8900

QUEENSLAND OFFICE:
PHONE: (07) 3265 5520