



ACCUWEIGH

**Onboard and Vehicle
Weighing Systems**

XW Wireless Crane Scale Range

Accuweigh's XW wireless crane scales are complete weighing systems designed for rough working conditions. The XW scales cover a wide range of applications such as cargo cranes, forest cranes, recycling cranes, material handlers, port cranes and industrial cranes. Typical applications are recycling of household waste and industrial waste, timber transport and forwarding, scrap handling, etc.

Scale Types

The XW wireless crane scales are available as nonautomatic scales for static weighing (OIML R76, 1000 divisions) and as automatic scales for dynamic weighing (OIML R51, class y(b) 500 divisions).

Main Features

- Wireless operation (minimal installation costs).
- Overload and torque protected, temperature compensated load cell.
- Integrated motion controller (for dynamic weighing).
- Accuweigh's XW wireless crane scales combine extremely low power consumption with an outstanding radio range. The radio is RTT&E certified.

Dynamic Weighing

The XW wireless crane scales are a true revolution in dynamic weighing. Thanks to the integrated motion controller and the specially-designed high-resolution load cell, the XW sets a new standard for crane scales in forestry and recycling as well as for material handlers and port cranes.

Options

All XW scales are available with the versatile and user friendly Bluescale route order software for Windows Mobile and BlueOfficeLite for Windows XP/ Vista. Further options - GSM/GPRS, GPS and RFID. Also available - a wide range of useful accessories for safe and easy weighing.

by



INTERMERCATO



Scales for Timber Transport, Forestry, Recycling

XW 50L

Weighing link for forestry and recycling

Measuring range: 100 – 5000kg

Also available as flange scale mounted between rotator and grab.



Scales for Material Handlers and Port Cranes

XW E

Weighing link for forestry and recycling

Measuring range: 100 – 5000kg

Also available as flange scale mounted between rotator and grab.

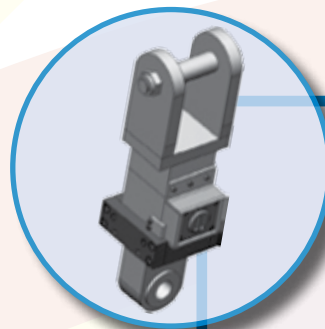

Scales for cargo cranes

XW 20 - XW 50

Weighing link for cargo cranes

Available for all crane makes.

Measuring range XW 20: 40 – 2000kg;

XW 50: 100 – 5000kg

Also available as flange scale mounted between rotator and grab.



XW SHV - LSH

Weighing hooks

Measuring range XW 20 SHV: 40 – 2000kg

XW 50 SHV: 100 – 5000kg

LSH Heavy Duty weighing hooks – capacity up to 20 000kg



Receiver - Board Computer

STD REMOTE CONTROL

Non-automatic scale for weight control only. For static or dynamic weighing. Bluetooth interface to mobile printer for simple receipts.



AUT REMOTE CONTROL

Automatic scale for dynamic weighing. Bluescale software for logging of all weighing data. GPRS and GPS optional, also download of data to PC via USB cable.



PRO REMOTE CONTROL

Automatic or non-automatic scale for static or dynamic weighing. Bluescale advanced software for route order planning and collection of municipal waste etc. Optional GPRS, GPS and download of data to PC via USB cable. RFID also available.



ACCESSORIES

- Cable remote control - switch or pedal - for cabin mounted monitors.
- 4-function radio remote control with display for radio operated cranes.
- Buzzer to confirm measuring.
- IP 65 LED signal tower for outdoor mount to confirm measuring.
- IP 54 LED signal tower for indoor mount to confirm measuring.
- IP 65 Weather protection box for outdoor mount of monitor.
- Desktop USB docking- and charging station.
- GSM/GPRS – GPS – RFID.
- Bluetooth thermo printer.



Accuweigh Pty Ltd

WESTERN AUSTRALIA (HEAD OFFICE):
PHONE: (08) 9259 5535

SOUTH AUSTRALIA OFFICE:
PHONE: (08) 8447 5011

NEW SOUTH WALES (SYDNEY) OFFICE:
PHONE: (02) 9728 4877



www.accuweigh.com.au

VICTORIA OFFICE:
PHONE: (03) 9548 5554

NEW SOUTH WALES (NEWCASTLE) OFFICE:
PHONE: (02) 4966 8900

QUEENSLAND OFFICE:
PHONE: (07) 3265 5520