



FEATURES

- Highly Accurate and Reliable Design
- AC Gearmotor
- Low Profile Design
- Fully Enclosed Option
- Dust Tight Version
- 1:20 Control Range (95% Turn Down)
- Self Aligning and Tensioning Weighbelt

APPLICATION

Weighfeeders can be configured to continuously control the feed of material, measure a feed rate or batch a quantity of material into industrial process.

The sturdy, reliable design makes the TWM suitable for the use in the following industries:

- Quarry, Sand and Gravel
- Chemical
- Wheat and Grain
- Livestock feeds
- Mining and Minerals

Over volumetric feeding devices, the application of weighfeeders results in improved final product.

CONSTRUCTION

The standard weighfeeder package consists of:

- C section frame design, self supporting during belt change.
- Self tensioning (gravity take-up unit) and self aligning weighbelt.
- Inner and outer belt scrapers.
- Stainless Steel loadcells mounted under the frame, away from material ingress.
- AC drive motor with control range 1:20 (95% turn down) without forced fan cooling.
- Calibration weight receptors for ease of calibration.

Optionally can include:

- Weigh belts with flexible sidewalls.
- Fully enclosed units.
- Dust tight units.
- Special frame configurations.

OPERATION

The belt load (q , kg/m) is accurately measured via a single weigh idler mounted on two stainless steel loadcells. The non drive side of the motor is fitted with a speed sensor which accurately measures the speed (v , m/s). These two signals are then connected to the controller which accurately evaluates the feedrate (I , kg/h). The controller then sends a closed loop control magnitude (Y , mA) to either direct coupled drive or the pre feeder.

The infeed hopper is configured to suit the specific material to be fed, including vibrating hoppers for wet/sticky material and dust settling chambers for fine materials prone to flushing.

DIMENSIONS

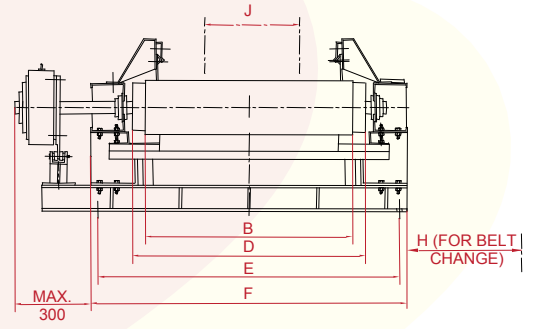
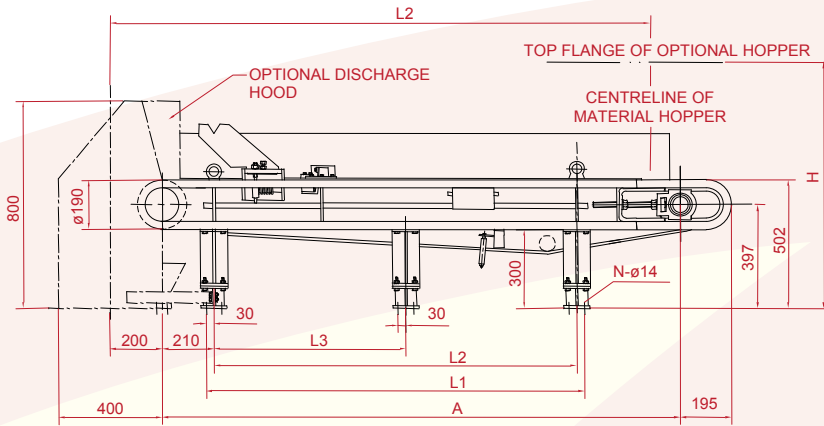

AXLE CENTRES (NOMINAL)

BELT WIDTHS

A	1,300	2,000	2,700	3,500	4,000	4,500	5,000					
L1	760	1,460	2,160	2,960	3,460	3,960	4,460					
L2	700	1,400	2,100	2,900	3,400	3,900	4,400					
L3	N/A (Two Support Legs)			1,400	2,100	2,100	2,100					
L4	1,200	1,900	2,600	3,400	3,900	4,400	4,900					
N	8	8	8	12	12	12	16					
B								650	800	1,000	1,200	1,400
D								800	950	1,150	1,350	1,550
E								1,010	1,160	1,360	1,560	1,760
F								1,070	1,220	1,420	1,620	1,820
J								350	500	700	900	1,100
H								850	1,000	1,200	1,400	1,600

MATERIAL FEED HOPPER CONFIGURATIONS

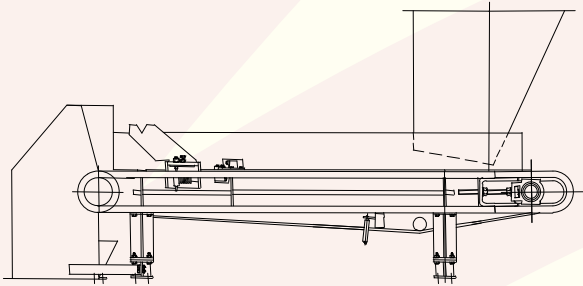

Discharge Hopper for free flowing materials

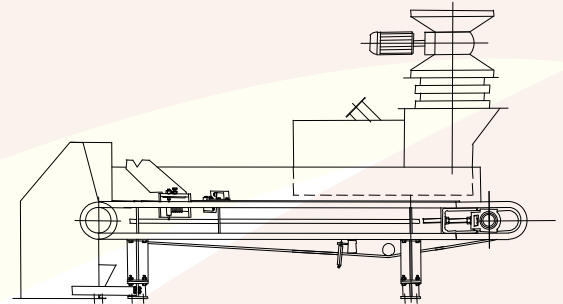

Star feeder with settling (dust control) chamber for fine powders, meal or dust

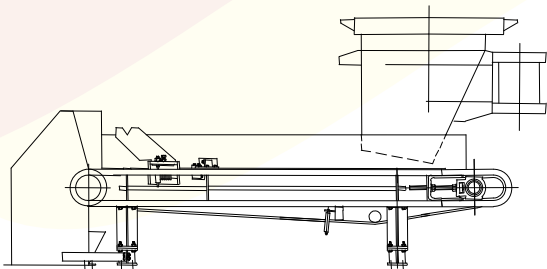

Vibrating Hopper for Wet/Sticky Materials

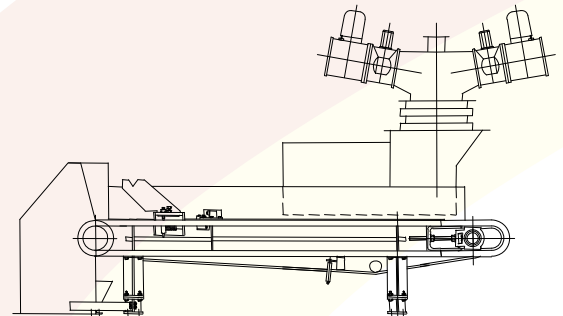

Flow Control Gate with settling chamber

Accuweigh Pty Ltd

WESTERN AUSTRALIA (HEAD OFFICE):
PHONE: (08) 9259 5535

SOUTH AUSTRALIA OFFICE:
PHONE: (08) 8447 5011

NEW SOUTH WALES (SYDNEY) OFFICE:
PHONE: (02) 9728 4877



www.accuweigh.com.au

VICTORIA OFFICE:
PHONE: (03) 9548 5554

NEW SOUTH WALES (NEWCASTLE) OFFICE:
PHONE: (02) 4966 8900

QUEENSLAND OFFICE:
PHONE: (07) 3265 5520