



### DESCRIPTION

Feature packed and technology driven, the PT5000 Series is an advanced high technology shearbeam loadcell range. Our flagship design meets the highest standards worldwide.

Manufactured in both imperial and metric capacities the PT5000 is approved in many jurisdictions around the world.

Being industry-standard in size it replaces many older less accurate shearbeam loadcells, which have much lower environmental protection. Six metric capacities from 250kg to 5t and Six imperial capacities from 500lb to 10klb allows the professional scale manufacturer to standardise their whole platform scale offering using one single model, reducing spares holdings and increasing brand awareness.

The PT5000 is an ideal selection for the volume OEM scale manufacturer, high resolution class III L:10,000 and III:9500 NTEP device, and similar approvals in other areas. It is insensitive to axial loads, yet super accurate.

Constructed in alloy tool steel and electroless nickel plated for lifelong protection, offered with a selection of mounting accessories.

### APPLICATIONS

- Floor Scales
- Hopper, Silo and Bin Weighing
- Hopper Scales and Net Weighing Scales

### FEATURES

- High Accuracy Solid Construction
- Approved in Many Jurisdictions
- Industry-Standard Allows Easy Interchange
- Offered in Metric and Imperial Capacities
- Matched mV/V Outputs

### TECHNICAL DATA

Signal Output at Capacity	3mV/V $\pm$ 0.1%
Linearity Error	<0.017% FSO
Non-Repeatability	<0.010% FSO
Combined Error	<0.023% FSO
Hysteresis	<0.020% FSO
Creep/Zero Return (30 Minutes)	<0.023%/0.017% FSO
Zero Balance	<1% Capacity
Temperature Effect on Span (/10°C)	<0.010% FSO
Temperature Effect on Zero (/10°C)	<0.015% FSO
Operating Temperature Range	-18°C to +65°C
Compensated Temperature Range	-10°C to +40°C
Storage Temperature	-50°C to +85°C

Service Load	100% Capacity
Safe Load	150% Capacity
Safe Side Load	100% Capacity
Ultimate Load	300% Capacity
Input Resistance	415 $\Omega$ $\pm$ 15 $\Omega$
Output Resistance	352 $\Omega$ $\pm$ 3 $\Omega$
Insulation Resistance	>5,000M $\Omega$ @ 100VDC
Excitation Voltage (Recommended)	5V to 15V AC/DC
Excitation Voltage (Maximum)	18V AC/DC
Material	Alloy Tool Steel
Finish	Electroless Nickel Plated
Sealing	IP-67

# DIMENSIONS

## IMPERIAL MODELS

Capacity	A	B	C	D	E	F	G	H	J	L	Deflection	Weight
500lb	0.63	1.00	3.00	5.12	1.25	1.25	0.53	1/2-20 UNF-2B	Ø0.53 x 0.50	2.25	0.013	1.7lb
1klb, 2.5klb, 4klb	0.63	1.00	3.00	5.12	1.25	1.25	0.53	1/2-20 UNF-2B	Ø0.53 x 0.50	2.25	0.017 to 0.025	4.0lb
5klb, 10klb	0.75	1.50	3.75	6.75	1.50	1.50	0.78	3/4-16 UNF-2B	Ø0.78 x 0.75	3.00	0.025 to 0.035	6.5lb

All Dimensions in Inches Unless Noted Otherwise

## METRIC MODELS

Capacity	A	B	C	D	E	F	G	H	J	L	Deflection	Weight
250kg	16.0	25.4	76.2	130.0	32.0	32.0	13.5	M12 x 1.75-6H	Ø13.5 x 16.0	57.2	0.33	0.8kg
500kg, 1t, 2t	16.0	25.4	76.2	130.0	32.0	32.0	13.5	M12 x 1.75-6H	Ø13.5 x 16.0	57.2	0.432 to 0.635	1.8kg
2.5t, 5t	19.0	38.1	95.3	171.5	38.1	38.1	20.5	M18 x 2.50-6H	Ø20.5 x 19.0	76.2	0.635 to 0.889	2.9kg

All Dimensions in mm Unless Noted Otherwise

## CABLE

COLOUR	DESIGNATION
Red	+ Excitation
Black	- Excitation
Green	+ Signal
White	- Signal

Type: 4.5mm, Screened, PUR Sheath, 4-Core, 0.24mm<sup>2</sup> (24 AWG)

Length: 6m

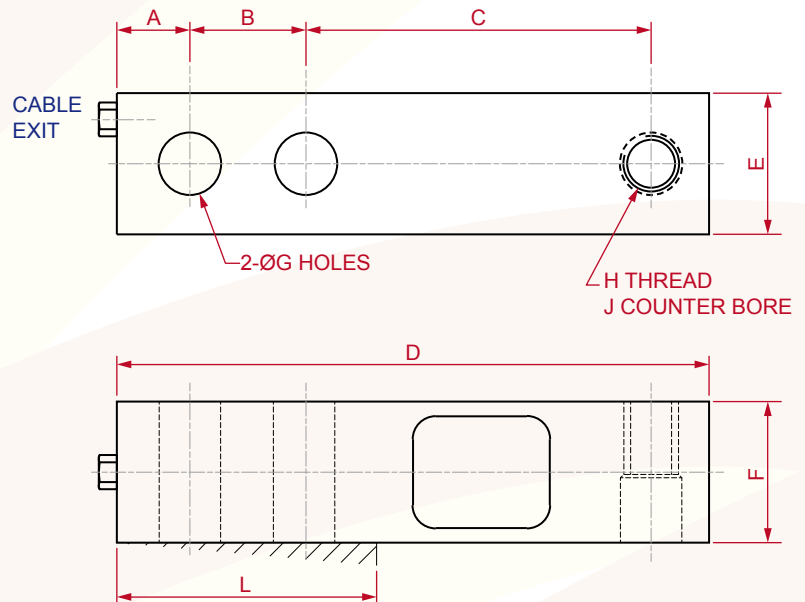

## MOUNTING ACCESSORIES

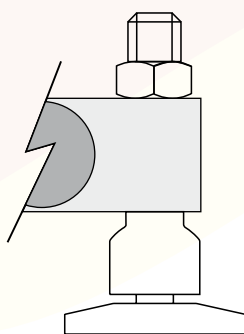

SWIVEL FOOT

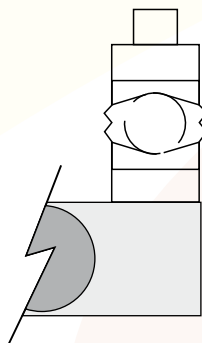

BALL & CUP

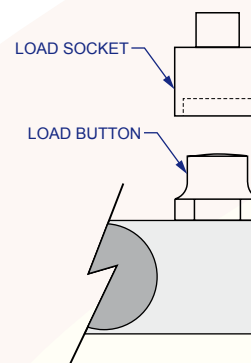

LOAD SOCKET & BUTTON

Accuweigh Pty Ltd

WESTERN AUSTRALIA (HEAD OFFICE):  
PHONE: (08) 9259 5535

SOUTH AUSTRALIA OFFICE:  
PHONE: (08) 8447 5011

NEW SOUTH WALES (SYDNEY) OFFICE:  
PHONE: (02) 9728 4877



[www.accuweigh.com.au](http://www.accuweigh.com.au)

VICTORIA OFFICE:  
PHONE: (03) 9548 5554

NEW SOUTH WALES (NEWCASTLE) OFFICE:  
PHONE: (02) 4966 8900

QUEENSLAND OFFICE:  
PHONE: (07) 3265 5520