

PT2000

SINGLE-POINT LOADCELL



APPLICATIONS

- Low Cost Retail Scales
- Low Cost Bench Scales
- Hopper Scales and Net Weighing Scales

FEATURES

- Marine Grade Anodised
- Protected with SURESEAL™
- Industry-Standard Interchange Design
- Generous Platform Sizes Up to 400mm x 400mm
- Overload Protection Facility

DESCRIPTION

The PT2000 Series is PT's most popular single-point model, used in high numbers in shop counter retail and bench scales. The PT2000 is available in nine capacities from 5kg to 100kg. Its industry-standard design allows interchange with many manufacturers models.

A popular cell for retail scale manufacture because of its generous platform size of 400mm x 400mm, also used extensively in belt conveyer and check weighing applications.

Protected with SURESEAL to IP-66, the PT2000 is standard with an overload protection facility built-in. Marine grade anodised and designed to have low sensitivity to off-centre loading, it's a perfect loadcell selection for the volume scale manufacturer.



TECHNICAL DATA

Signal Output at Capacity	2mV/V ±10%
Linearity Error	<0.020% FSO
Non-Repeatability	<0.010% FSO
Combined Error	<0.025% FSO
Hysteresis	<0.015% FSO
Creep/Zero Return (30 Minutes)	<0.030%/0.020% FSO
Zero Balance	<3% Capacity
Temperature Effect on Span (/10°C)	<0.010% FSO
Temperature Effect on Zero (/10°C)	<0.015% FSO
Operating Temperature Range	-30°C to +70°C
Compensated Temperature Range	-10°C to +40°C
Storage Temperature	-50°C to +70°C

Service Load	100% Capacity
Safe Load	150% Capacity
Ultimate Load	300% Capacity
Input Resistance	425Ω ±15Ω
Output Resistance	350Ω ±3Ω
Insulation Resistance	>5,000MΩ @ 100VDC
Excitation Voltage (Recommended)	5V to 12V AC/DC
Excitation Voltage (Maximum)	15V AC/DC
Eccentric Loading (Effect/cm)	<0.0074% FSO
Deflection at Rated Capacity	<0.4mm
Material	Aluminium
Finish	Marine Anodised
Sealing	IP-66

DIMENSIONS

Capacity	A	Weight
5kg, 7kg, 10kg, 15kg, 20kg, 30kg	20	0.35kg
50kg, 75kg, 100kg	35	0.40kg

All Dimensions in mm Unless Noted Otherwise

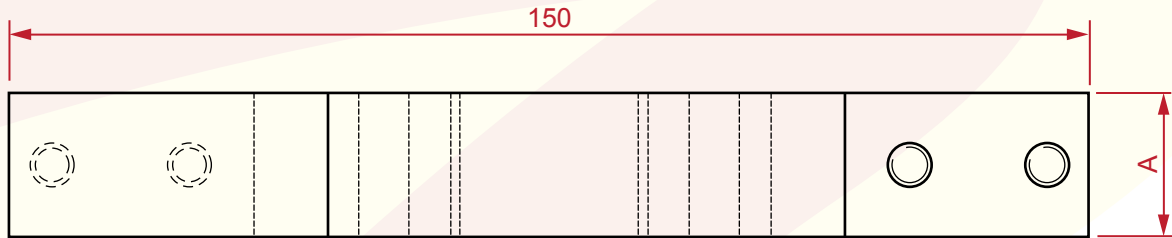

TOP VIEW

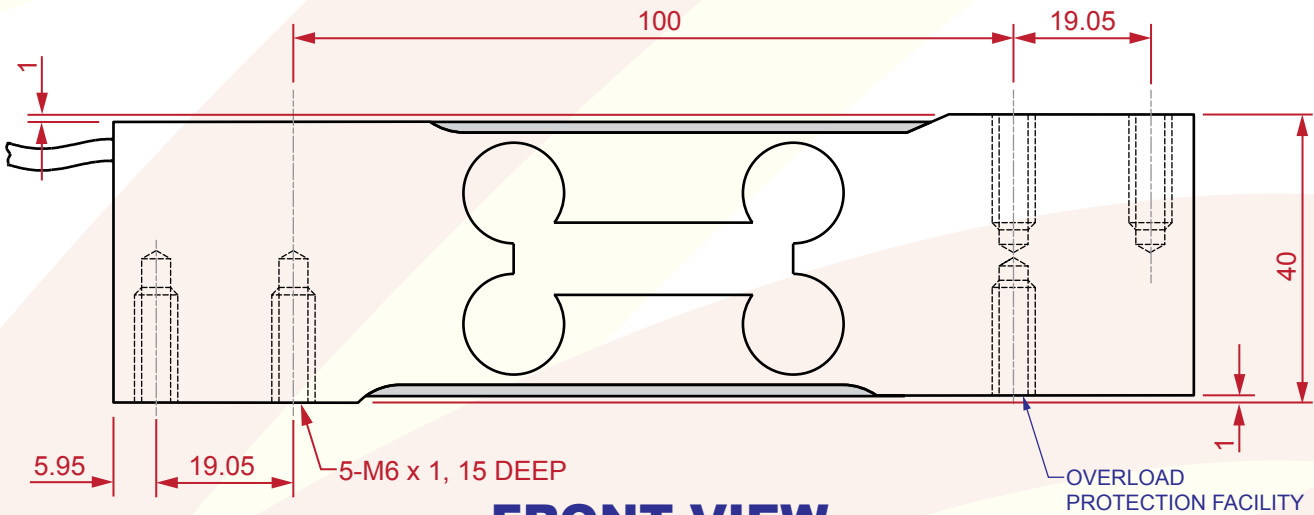

FRONT VIEW

CABLE

COLOUR	DESIGNATION
Red	+ Excitation
Black	- Excitation
Green	+ Signal
White	- Signal

Type: 4mm, Screened, PVC Sheath,
0.09mm² (28 AWG)

Length: 2m

Accuweigh Pty Ltd

WESTERN AUSTRALIA (HEAD OFFICE):
PHONE: (08) 9259 5535

SOUTH AUSTRALIA OFFICE:
PHONE: (08) 8447 5011

NEW SOUTH WALES (SYDNEY) OFFICE:
PHONE: (02) 9728 4877



www.accuweigh.com.au

VICTORIA OFFICE:
PHONE: (03) 9548 5554

NEW SOUTH WALES (NEWCASTLE) OFFICE:
PHONE: (02) 4966 8900

QUEENSLAND OFFICE:
PHONE: (07) 3265 5520