



ACCUWEIGH

Onboard and Vehicle
Weighing Systems

AW2500

**DOUBLE-ENDED
SHEARBEAM LOADCELL**



DIMENSIONS

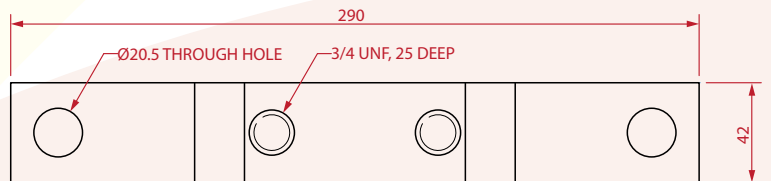

TOP VIEW

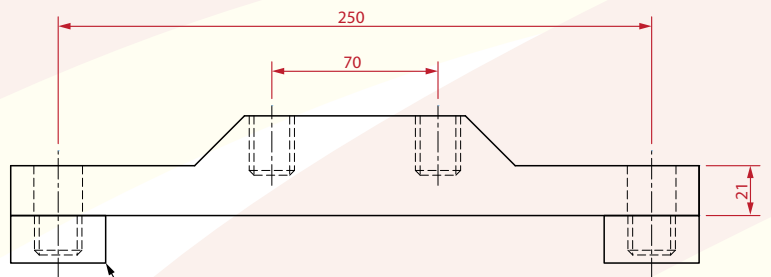

FRONT VIEW

TECHNICAL DATA

Maximum Capacity	2,500kg - Dynamic 4,000kg - Static
Construction	4340 Alloy Steel, 1,300N/mm ²
Cell Weight	13kg
Excitation Voltage	8-15VDC
Input Impedance	350Ω to 372Ω
Output Impedance	350Ω
Calibrated	4mV Output, 9.944V Supply 3.48t Approximately 0.4mV/V @ 3.5t

10m CABLE SUPPLIED WITH INTER-LINK CONNECTOR AS STANDARD

- 1 = - EXCITATION [BLACK]
- 2 = - SIGNAL [WHITE]
- 3 = + EXCITATION [RED]
- 4 = + SIGNAL [GREEN]

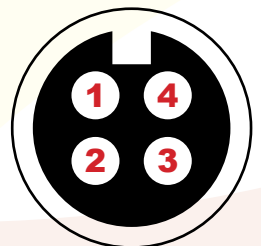

Accuweigh Pty Ltd

WESTERN AUSTRALIA (HEAD OFFICE):
PHONE: (08) 9259 5535

SOUTH AUSTRALIA OFFICE:
PHONE: (08) 8447 5011

NEW SOUTH WALES (SYDNEY) OFFICE:
PHONE: (02) 9728 4877



www.accuweigh.com.au

VICTORIA OFFICE:
PHONE: (03) 9548 5554

NEW SOUTH WALES (NEWCASTLE) OFFICE:
PHONE: (02) 4966 8900

QUEENSLAND OFFICE:
PHONE: (07) 3265 5520