



# HR-200 ANALYTICAL BALANCE

Every A&D balance is designed for maximum performance. The HR-200 gives you the capability you need, at the price you deserve.

by   
A&D MERCURY PTY LTD

## FEATURES

### SIMPLE OPERATION

Perform any operation with simple, clearly marked key entry.

### ADAPTS TO YOUR ENVIRONMENT

- **Mode Key:** Changes weighing unit and alters condition of response to immediately adapt to changing environmental conditions.
- **Zero Point Calibration:** Calibrates zero independently of span.
- **Selectable Calibration Mass Capability:** Corrects for errors in calibration weight.
- **Wide Range of Software Parameters:** Controls reaction to environment and communications output.
- **Range Key:** Disables least significant digit for better display stability in unstable areas.
- **Strong Construction:** Aluminium alloy that won't chip, crack or wear out for many years of trouble-free use.

### GREATEST FLEXIBILITY

- Multiple weighing modes.
- Optional battery pack for portability and use in areas with low power problems.
- Underhook capability for density measurement and weighing magnetic material.
- System Diagnostics provides error signals advising of: Low Battery, Overload Error, Weighing Pan Error, Power Failure Error, Stability Error, Digital Re-Zero Error, Zero-point Error and Calibration Errors.
- Digital Tare Capability: Allows manual or computer input of a tare weight. Use in wide range of tracking studies, such as daily weight gain/loss measurements in test animals, standard deviation, etc. Or the input of tare weights.

### BALANCE ID NUMBER ALLOWS CALIBRATION OUTPUT VERIFICATION

Allows GLP or LIMS balance management by outputting the ID number and weight used to calibrate the balance, to A&D's AD-8121 printer or computer, which then can print date, time, balance ID number and calibration weight.



```
MODEL      HR-200
S/N        12345678
ID          1000 -A
DATE       01/01/94
11:18:30 AM
CALIBRATED
           +000.0000  g
           +200.0002  g
CAL.WEIGHT
SIGNATURE
```



## PERIPHERALS

- AD-1653: Density Determination Kit
- AD-8121B: Dot Matrix Compact Printer
- AD-8118B: Universal Printer
- AD-8524: Keyboard Adaptor
- AD-8922: Remote Display

## OPTIONS

- OP-03 Serial Interface (RS-232C/Current Loop)
- OP-05 Serial Interface (Current Loop)
- OP-09 Rechargeable Battery Pack

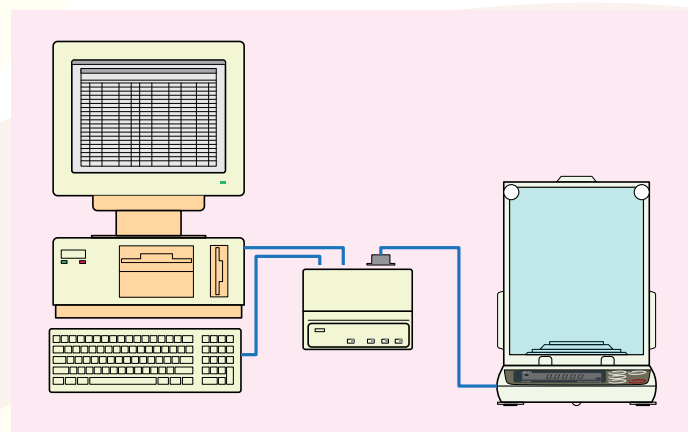

**AD-8524 KEYBOARD ADAPTOR**



**OPTION OP-09 RECHARGEABLE BATTERY PACK**



**AD-8121B PRINTER**



**AD-8118B PRINTER**



**AD-8922 REMOTE DISPLAY AND CONTROLLER**



**AD-1653 DENSITY DETERMINATION KIT**

## DIMENSIONS

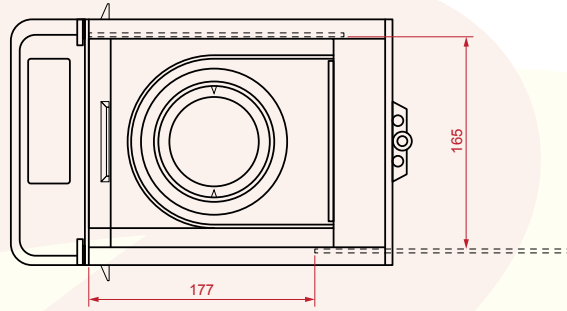

**TOP VIEW**

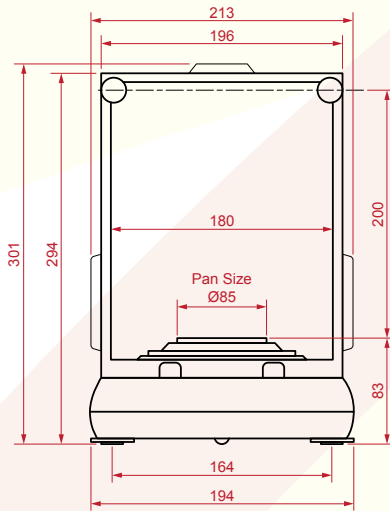

**FRONT VIEW**

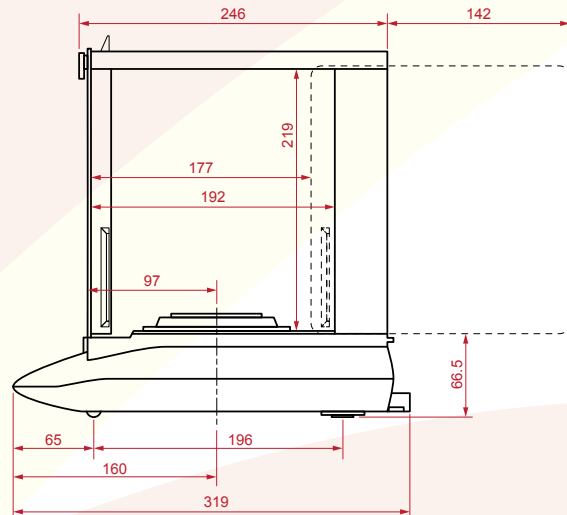

**SIDE VIEW**

## SPECIFICATIONS

| MODEL                      |                   | HR-200   |
|----------------------------|-------------------|--|
| Capacity                   |                   | 210g   |
| Resolution                 |                   | 0.1mg  |
| Repeatability              |                   | 0.1mg  |
| Linearity                  |                   | ±0.2mg   |
| Sensitivity Drift          |                   | ±2ppm/°C   |
| Approx. Stabilisation Time |                   | 3s   |
| Weighing Units             |                   | g, mg, oz, ozt, ct, dwt, mom, GN, tola, tael, %, pcs |
| Operating Temperature      |                   | 5°C to 40°C, <85% Relative Humidity                  |
| Display Refresh Rate       |                   | 5 Times/Second                                       |
| Counting Mode              | Minimum Unit Mass | 0.1mg  |
|                            | Number of Samples | 10, 25, 50 or 100 Pieces                             |
| Percent Minimum Division   |                   | 0.01%, 0.1%, 1% (Auto Prompt)                        |
| Standard Accessories       |                   | Manual, AC Adaptor, Protective Cover                 |

**Accuweigh Pty Ltd**

WESTERN AUSTRALIA (HEAD OFFICE):  
PHONE: (08) 9259 5535

SOUTH AUSTRALIA OFFICE:  
PHONE: (08) 8447 5011

NEW SOUTH WALES (SYDNEY) OFFICE:  
PHONE: (02) 9728 4877



[www.accuweigh.com.au](http://www.accuweigh.com.au)

VICTORIA OFFICE:  
PHONE: (03) 9548 5554

NEW SOUTH WALES (NEWCASTLE) OFFICE:  
PHONE: (02) 4966 8900

QUEENSLAND OFFICE:  
PHONE: (07) 3265 5520